

# Parts Information:

## Long Reach Engine Crane with Extendable Legs 1 Tonne

### Model No: SC10LR.V3

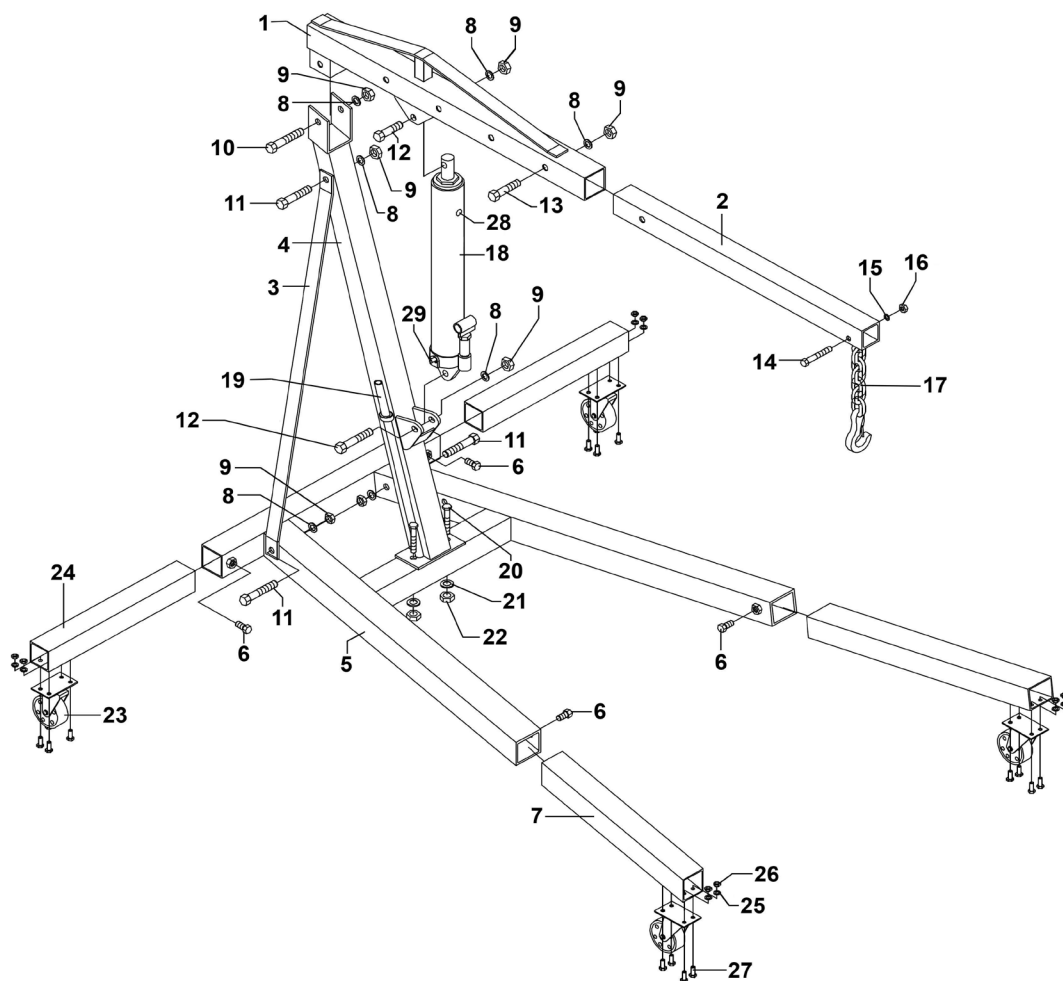

Item	Part No.	Description	Qty
1	SC10LR-V3-01	Boom	1
2	SC10LR-V3-02	Boom Extension	1
3	SC10LR-V3-03	Support Brace	2
4	SC10LR-V3-04	Main Post	1
5	SC10LR-V3-05	Frame Base	1
6	SS1225.S	Hex Head Set Screw M12 x 25mm	4
7	SC10LR-V3-07	Front Leg	2
8	FWM16.S	Flat Washer M16	7
9	SN16.S	Steel Nut M16	7
10	HHB16110.S	Hex Head Bolt M16 x 110mm	1
11	HHB16100.S	Hex Head Bolt M16 x 100mm	3
12	SC10LR-V3-12	Hex Head Bolt M16 x 85mm	2
13	HHB1690.S	Hex Head Bolt M16 x 90mm	1
14	HHB1280.S	Hex Head Bolt M12 x 80mm	1
15	FWM12.S	Flat Washer M12	1
16	SN12.S	Steel Nut M12	1

Item	Part No.	Description	Qty
17	SC10LR-V3-17	Chain & Hook Assembly	1
18	SC10LR-V3-18	Hydraulic Ram	1
19	SC10LR-V3-19	Pump Handle	1
20	HHB14100.S	Hex Head Bolt M14 x 100mm	2
21	FWM14.S	Flat Washer M14	2
22	SN14.S	Steel Nut M14	2
23	SC10LR-V3-23	Wheel, Swivel Castor, 4-Bolt Fixing (Ø87 x 30 x Ø8 Bore x 114mm)	4
24	SC10LR-V3-24	Rear Leg	2
25	FWM8.S	Flat Washer M8	16
26	SN8.S	Steel Nut M8	16
27	SS820.S	Hex Head Set Screw M8 x 20mm	16
28	SC10LR-V3-28	Oil Filler Plug	1
29	SC10LR-V3-29	Release Valve	1
--	SC10LR-V3-RK	Repair Kit (Not Shown)	1

**NOTE:** It is our policy to continually improve products and as such we reserve the right to alter data, specifications and component parts without prior notice. There may be alternative versions of this product, please contact us should you require this information.

**IMPORTANT:** No liability is accepted for incorrect use of product. Spare parts must be fitted by a competent person

**WARRANTY:** Guarantee is 12 months from purchase date, proof of which will be required for any claim.

Jack Sealey Ltd t/a Sealey Group, Kempson Way, Suffolk Business Park, Bury St Edmunds, Suffolk, IP32 7AR UK

Jack Sealey (EU) Ltd t/a Sealey Group, Farney Street, Carrickmacross, Co. Monaghan, A81 PK68 Ireland

Tel: 01284 757500 • Email: sales@sealey.co.uk • Web: www.sealey.co.uk